

[Afficher tous les 14 produits de la même famille.](#)

## Adaptateur Anneau Lumineux VZM

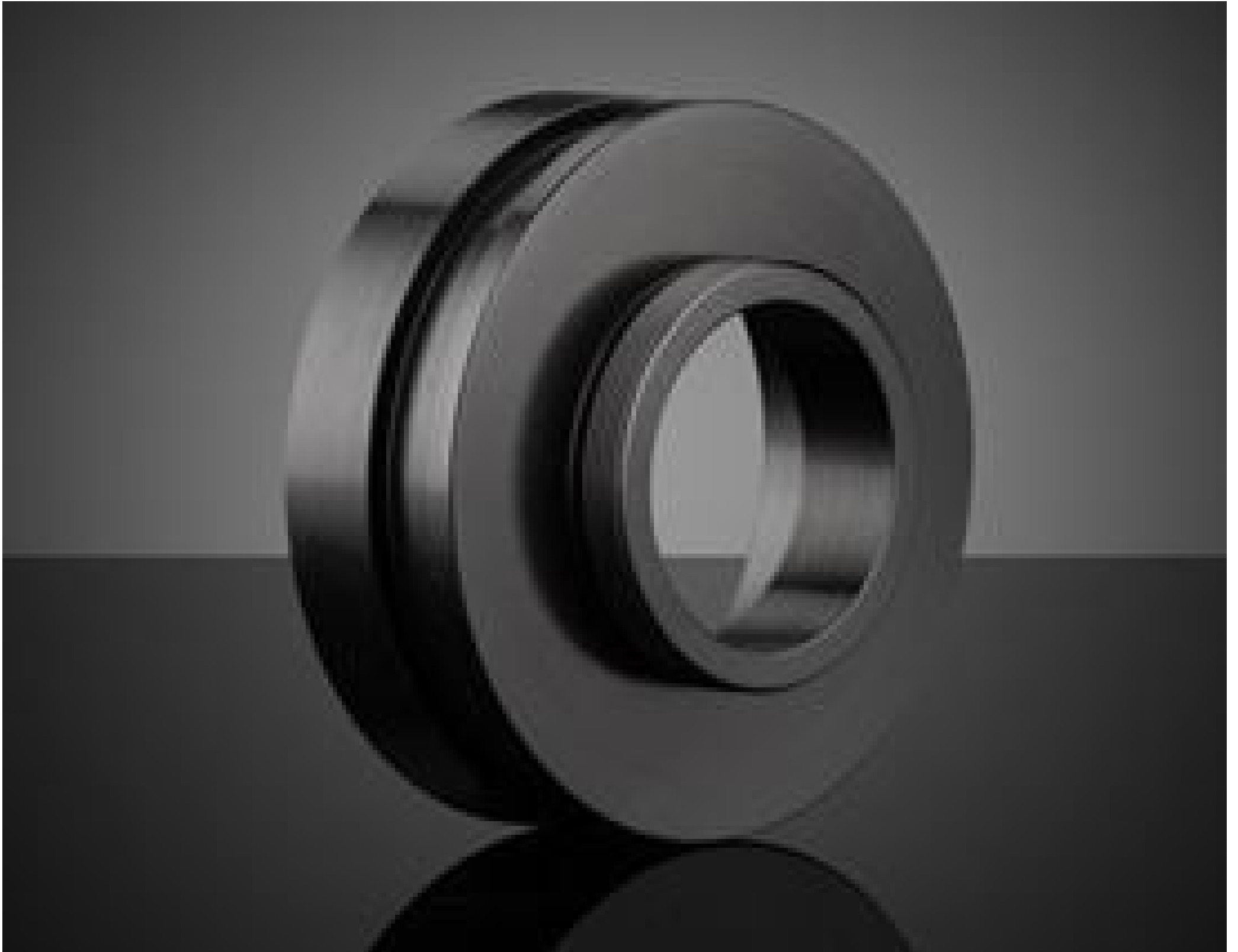

Stock #59-854 **20+ In Stock**

- 1 + €107<sup>,00</sup>

**AJOUTER AU PANIER**

### Prix sur Quantité

Qté 1+	€107,00 prix unitaire
Need More?	<a href="#">Demande de Devis</a>

Les prix sont indiqués hors TVA et droits applicables.

Espace téléchargement

### Caractéristiques du produit

**Remarque:**  
Compatible with 200i, 300i, and 450i models

**Type:**  
Lens Accessory

### Conformité réglementaire

**Conforme**

**RoHS 2015:**

**Certificate of Conformance:**



**VZM™ 450**

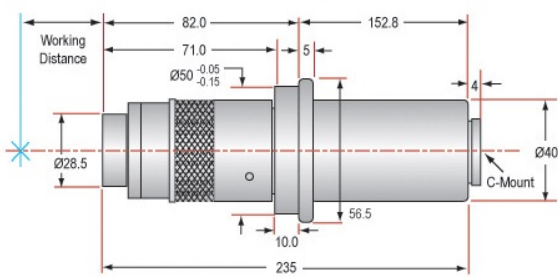

Units: mm

**VZM™ 1000i**

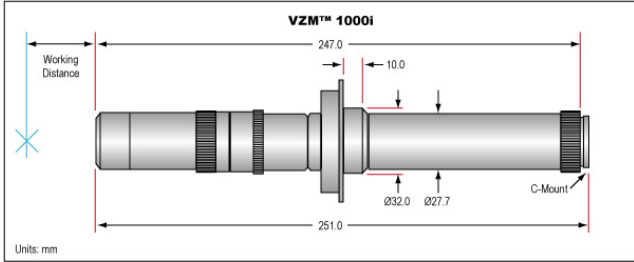

Units: mm

**VZM™ 200i**

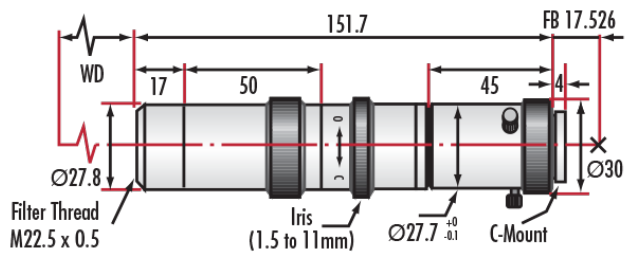

**Depth of Field Curves**  
Video Zoom Microscope VZM 450

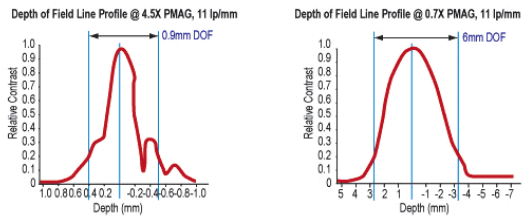

**Modulation Transfer Function Curves**  
Video Zoom Microscope VZM 450

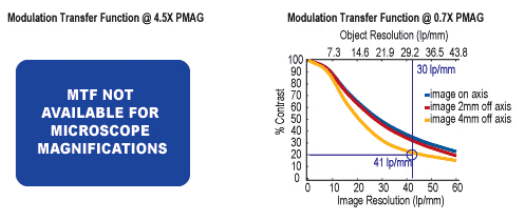

**VZM 600i**

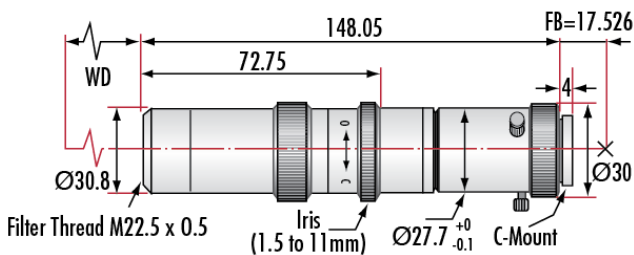

**Depth of Field Curves**  
Video Zoom Microscope VZM 450i

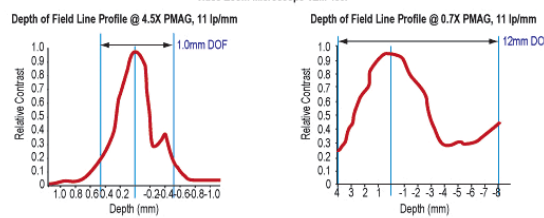

**Modulation Transfer Function Curves**  
Video Zoom Microscope VZM 450i

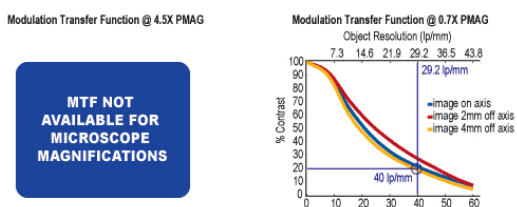

**Motorized VZM™ 450**

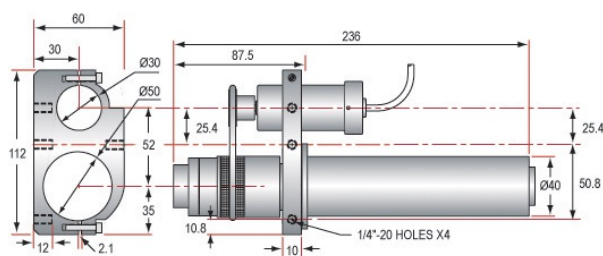

Units: mm

## VZM™ 450i

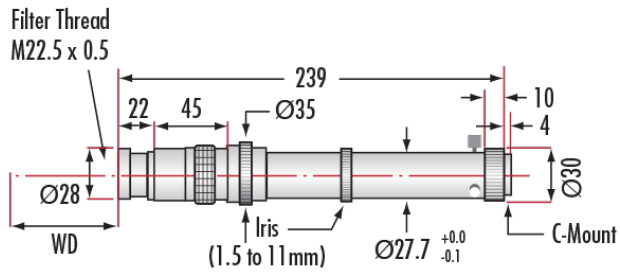

### Removable Mounting Flange, i-series (Fits Rack and Pinion #03-609)

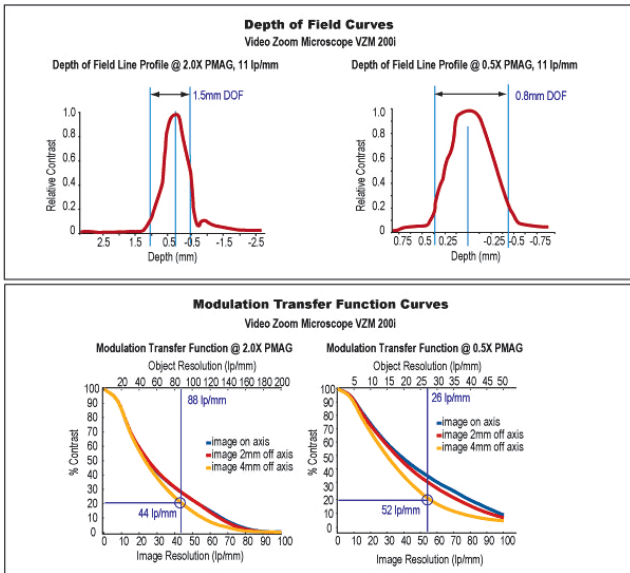
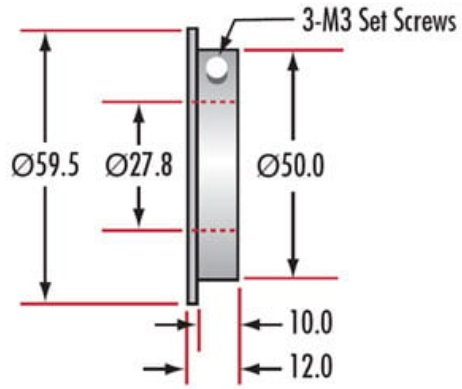

## VZM™ 100i

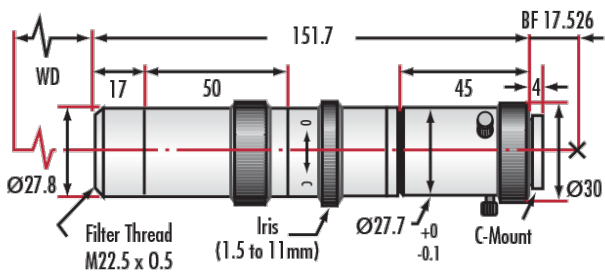

### Motorized VZM™ 300

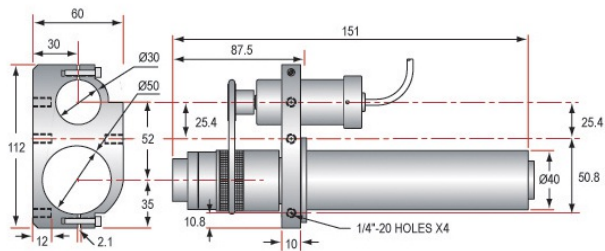

Units: mm

### Motorized VZM™ 1000

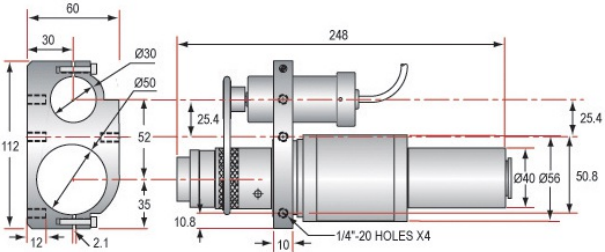

Units: mm

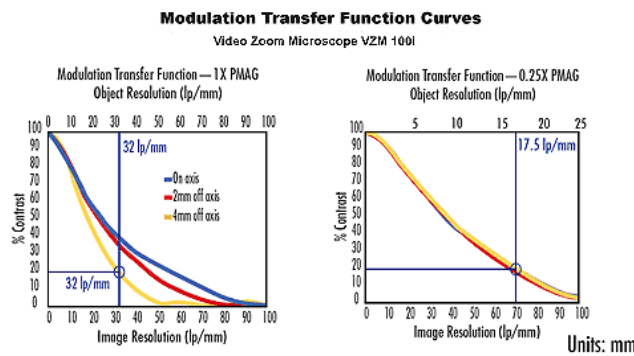
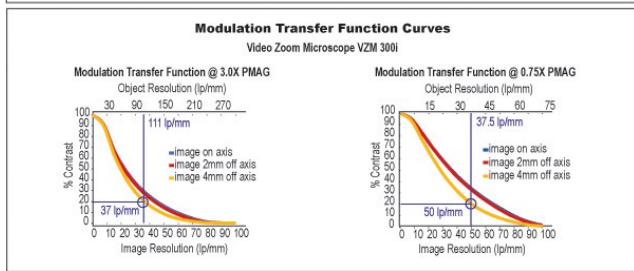
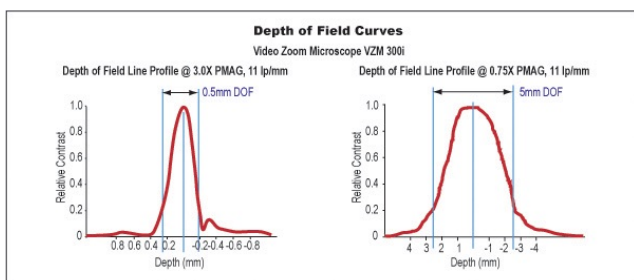

VZM Model	100i	200i	300	300i	450	450i	600i	1000	1000i
Zoom Ratio	4:1	4:1	4:1	4:1	6.4:1	6:1	6:1	4:1	4:1
Magnification	0.25 - 1X	0.5 - 2X	0.75 - 3X	0.75 - 3X	0.7 - 4.5X	0.75 - 4.5X	1 - 6X	2.5 - 10X	2.5 - 10X
Manual Iris	<input type="checkbox"/>	<input type="checkbox"/>		<input type="checkbox"/>		<input type="checkbox"/>	<input type="checkbox"/>		<input type="checkbox"/>
Rotatable Mount	<input type="checkbox"/>	<input type="checkbox"/>		<input type="checkbox"/>		<input type="checkbox"/>	<input type="checkbox"/>		<input type="checkbox"/>
Zoom Lock Adapter	<input type="checkbox"/>	<input type="checkbox"/>		<input type="checkbox"/>		<input type="checkbox"/>	<input type="checkbox"/>		<input type="checkbox"/>
Motorized Version			<input type="checkbox"/>		<input type="checkbox"/>			<input type="checkbox"/>	
Right Angle Version						<input type="checkbox"/>			

Primary Magnification	With 0.5X Lens	
	Minimum 0.25X	Maximum 1.0X
FOV (1/2" Horizontal Sensor)	24.0mm	6.0mm
Resolution in Object Space	10 lp/mm	40 lp/mm
Resolution in Image Space	40 lp/mm	40 lp/mm
Working Distance (±3mm)	152mm	152mm

Primary Magnification	With 0.5X Lens	
	Minimum 0.35X	Maximum 2.25X
FOV (1/2" Horizontal Sensor)	17.6mm	2.8mm
Resolution in Object Space	12 lp/mm	80 lp/mm
Resolution in Image Space	34 lp/mm	35.5 lp/mm
Working Distance (±3mm)	147mm	147mm

Primary Magnification	With 0.5X Lens		With 0.25X Lens	
	Minimum 0.35X	Maximum 2.25X	Minimum 0.175X	Maximum 1.125X
FOV (1/2" Horizontal Sensor)	17.6mm	2.8mm	35.2mm	5.6mm
Resolution in Object Space	12 lp/mm	80 lp/mm	6 lp/mm	40 lp/mm
Resolution in Image Space	34 lp/mm	35.5 lp/mm	34 lp/mm	35.5 lp/mm
Working Distance (±3mm)	147mm	147mm	275mm	275mm