

NOTES:

- 1. SUBSTRATE:  
OPTICAL GRADE GLASS
- 2. BANDWIDTH: 15nm
- 3. BLOCKING WAVELENGTH RANGE: 330 - 900nm
- 4. MINIMUM TRANSMISSION (%): >93 @ 502.5 – 517.5nm
- 5. ROHS COMPLIANT

NOTE: ARROW ON RING INDICATES PREFERRED DIRECTION OF PROPAGATION OF LIGHT.

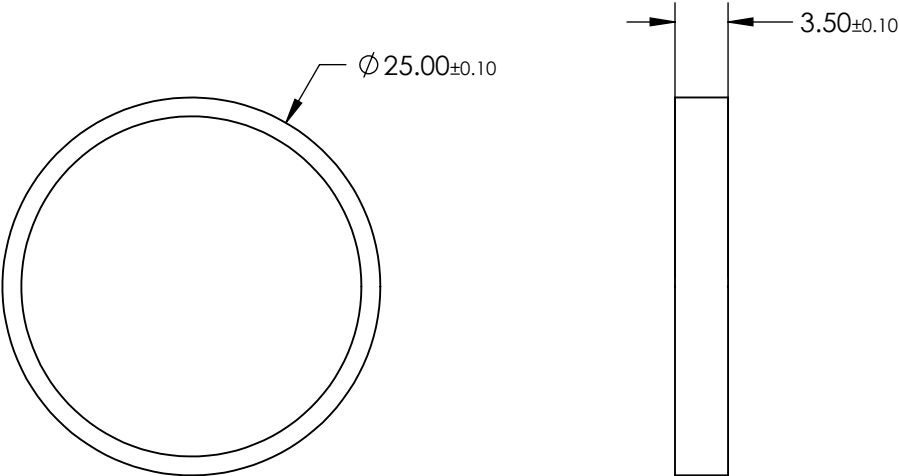
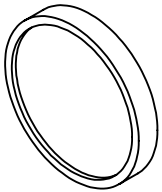

**FOR INFORMATION ONLY:  
DO NOT MANUFACTURE  
PARTS TO THIS DRAWING**

SPECIFICATIONS SUBJECT TO CHANGE WITHOUT NOTICE  
DIMENSIONS ARE FOR REFERENCE ONLY

	S1	S2
SHAPE	PLANO	PLANO
CONE HALF ANGLE (°)	7	7
OPTICAL DENSITY OD (AVERAGE)	>5	>5
SURFACE QUALITY	80 - 50	80 - 50
CLEAR APERTURE	≥ Ø 10.00	≥ Ø 10.10
BEVEL	PROTECTED AS NEEDED	PROTECTED AS NEEDED

THIRD ANGLE  
PROJECTION

ALL DIMS IN

mm

Edmund Optics®

TITLE

510nm CWL, >OD5, 20nm FWHM Bandpass  
Filter, 25mm Dia.

DWG NO

78427

SHEET  
18 OF 52