

- NOTES:
- 1. SUBSTRATE:
Zinc Selenide (ZnSe), CVD Grade
 - 2. CENTERING TOLERANCE:
EDGE THICKNESS VARIATION: <25µm
 - 3. COATING (APPLY ACROSS CLEAR APERTURE)

S1&S2: R(AVG) <4.5% @ 1 - 12µm
R(ABS) <8% @ 1 - 12µm

4. FINE GRIND SURFACE

5. SURFACE ROUGHNESS: <100 Ra

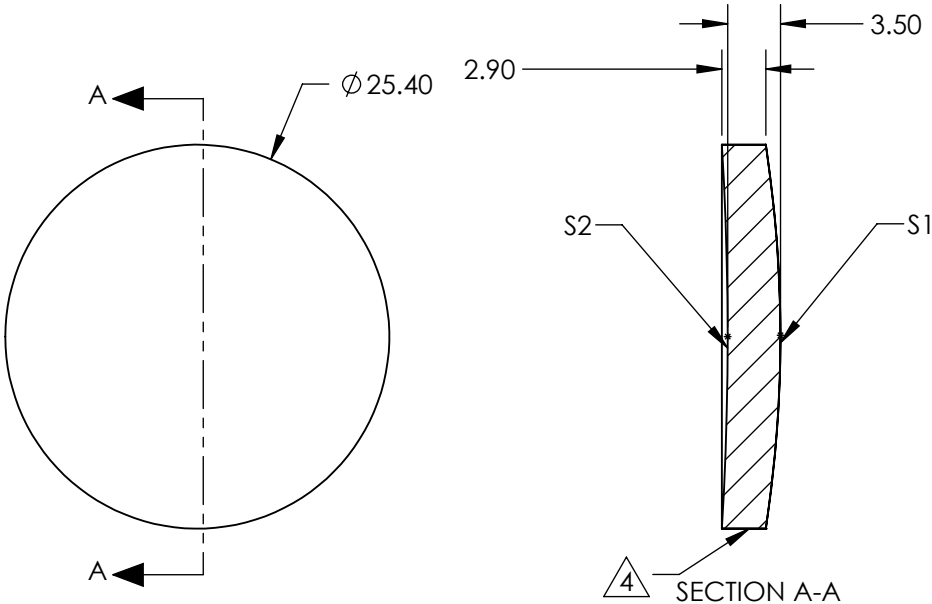

**FOR INFORMATION ONLY:
DO NOT MANUFACTURE
PARTS TO THIS DRAWING**

SPECIFICATIONS SUBJECT TO CHANGE WITHOUT NOTICE
DIMENSIONS ARE FOR REFERENCE ONLY

	S1	S2
SHAPE	CONVEX	CONCAVE
RADIUS	87.0281	212.8264
SURFACE QUALITY	60-40	60-40
CLEAR APERTURE	ø22.86	ø22.86
IRREGULARITY AT 632.8nm	λ/2	λ/2
BEVEL	PROTECTED AS NEEDED	PROTECTED AS NEEDED

THIRD ANGLE PROJECTION		Edmund Optics®	
ALL DIMS IN		TITLE	25.4mm Dia. x 101.6mm FL, 1 - 12µm BBAR Coated, ISP Optics ZnSe Aspheric Lens
mm		DWG NO	24975
			SHEET 14 OF 19