

NOTES:

1. SUBSTRATE:
ZERODUR®
2. S2 TO BE PARALLEL TO S1 TO WITHIN 30 ARCSEC
3. COATING (APPLY ACROSS CLEAR APERTURE)

S1: Enhanced Aluminum (250-700nm)
 R(AVG) >89% @ 250 - 450nm
 R(AVG) >85% @ 250 - 700nm
 S2: NONE

4. FINE GRIND SURFACE (ADD INK NOTE AS NEEDED)

5. CLEAR APERTURE AND COATING APERTURE ARE CENTERED ON SURFACE
6. SURFACE QUALITY SPECIFICATIONS APPLY ACROSS CLEAR APERTURE

7. ARROW ON EDGE POINTS TOWARDS 1/10TH WAVE SURFACE S1

8. ROHS COMPLIANT

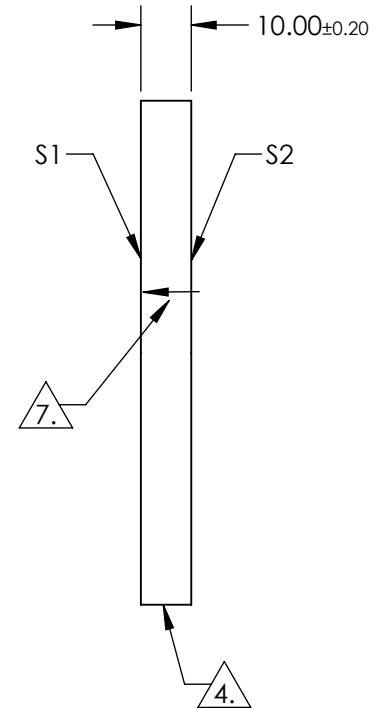
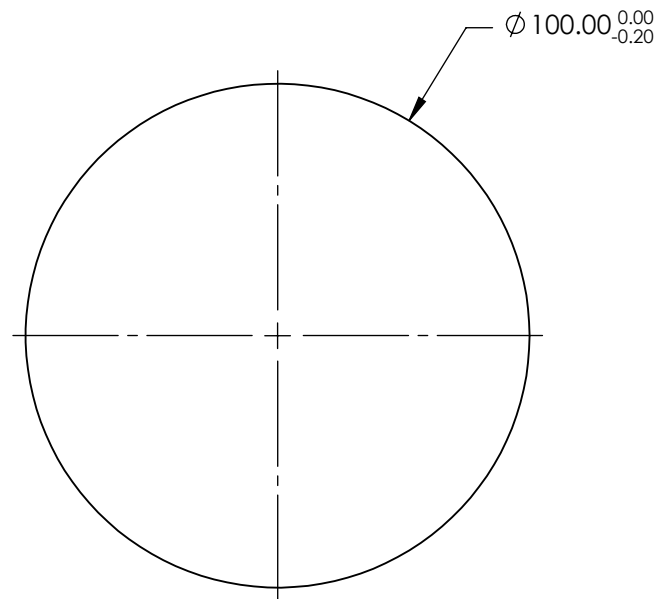

**FOR INFORMATION ONLY:
 DO NOT MANUFACTURE
 PARTS TO THIS DRAWING**

SPECIFICATIONS SUBJECT TO CHANGE WITHOUT NOTICE
 DIMENSIONS ARE FOR REFERENCE ONLY

	S1	S2
SHAPE	PLANO	PLANO
SURFACE QUALITY	20-10	COMMERCIAL POLISH
SURFACE FLATNESS	$\lambda/10$	N/A
CLEAR APERTURE	$\varnothing 90.00$	N/A
BEVEL	PROTECTED AS NEEDED	PROTECTED AS NEEDED

THIRD ANGLE PROJECTION

ALL DIMS IN

mm

Edmund Optics®

TITLE

100mm Dia. UV-Enhanced Aluminum Coated, $\lambda/10$ ZERODUR® Mirror

DWG NO

17802

SHEET
1 OF 1