

NOTES:

- 1. MATERIAL:  
BEAD-BLASTED ANODIZED ALUMINUM
- 2. INCLUDED HARWARE:  
(2) 1/4-20, 1 1/2" LONG BHCS  
(1) ENGLISH ALLEN WRENCH (#55-191)
- 3. ROHS: COMPLIANT

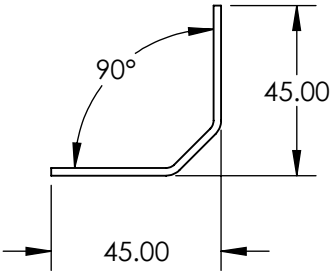
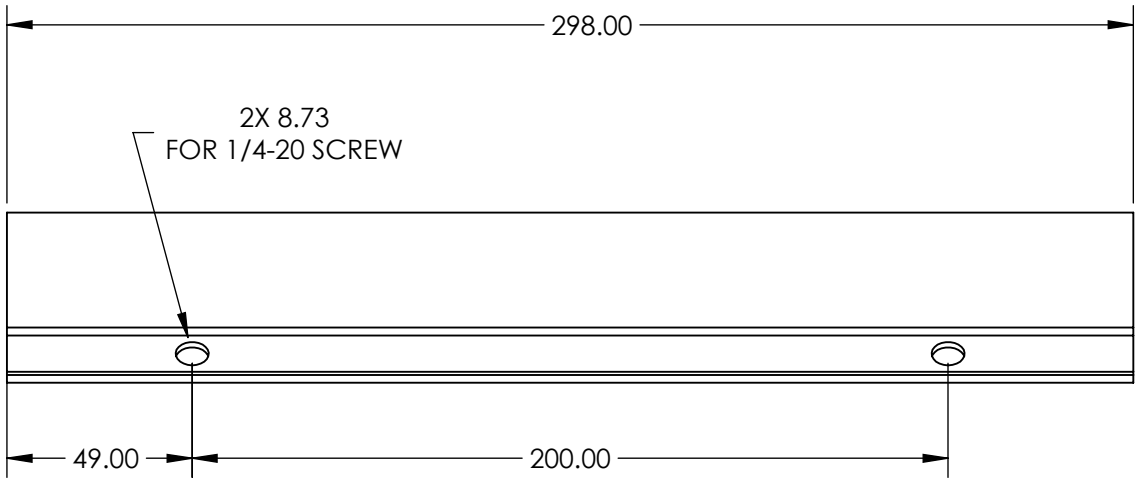

**FOR INFORMATION ONLY:  
DO NOT MANUFACTURE  
PARTS TO THIS DRAWING**

SPECIFICATIONS SUBJECT TO  
CHANGE WITHOUT NOTICE  
DIMENSIONS ARE FOR  
REFERENCE ONLY

**EO**® Edmund Optics®

THIRD ANGLE PROJECTION		TITLE	12" CORNER JOINING PLATES FOR LASER SAFETY BARRIERS	
ALL DIMS IN	mm	DWG NO	14737	SHEET 1 OF 1