

NOTES:

- 1. SUBSTRATE:
ZnSe
- 2. COATING (APPLY ACROSS COATING APERTURE)
HIGH-EFFICIENCY ANTI-REFLECTIVE COATING (10.6µm)
R(ABS) <0.2% @ 10.6µm @ 0° AOI
- 3. ROHS COMPLIANT

Ø 11.43
ENTRANCE
APERTURE

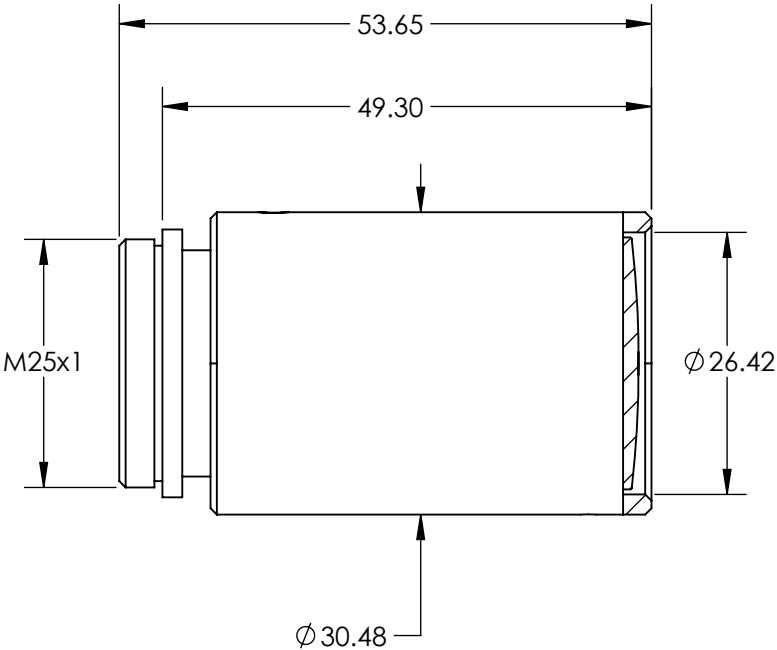
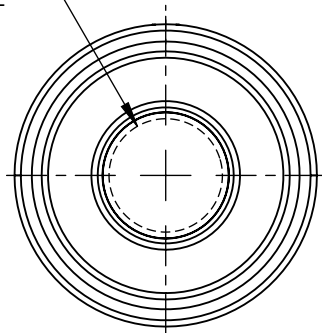

Ø 22.86
EXIT
APERTURE

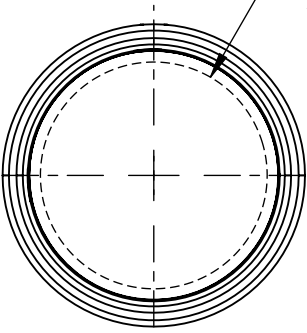

SPECIFICATIONS SUBJECT TO CHANGE WITHOUT NOTICE
DIMENSIONS ARE FOR REFERENCE ONLY

**FOR INFORMATION ONLY:
DO NOT MANUFACTURE
PARTS TO THIS DRAWING**

Edmund Optics®

THIRD ANGLE PROJECTION		TITLE	2X, CO2 Beam Expander	
ALL DIMS IN	mm	DWG NO	11363	SHEET 1 OF 1