

NOTES:

1. SUBSTRATE MATERIAL:  
N-BK7
2. COATING (APPLY ACROSS CLEAR APERTURE)
- S1 & S2: VIS 0° (425-675nm)  
R(AVG) ≤0.4% @ 425 - 675nm
3. FINE GROUND SURFACE
4. RoHS COMPLIANT

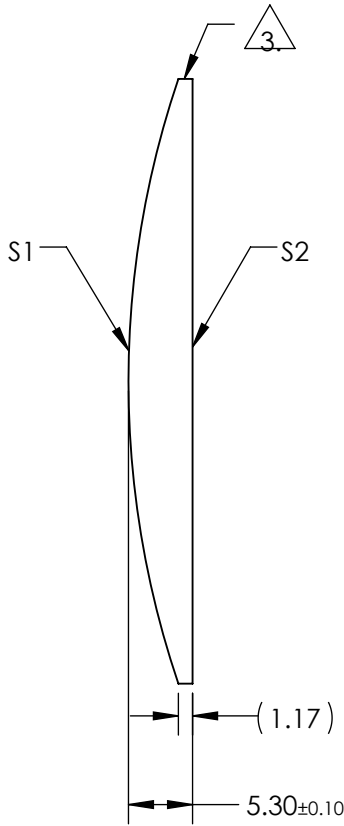
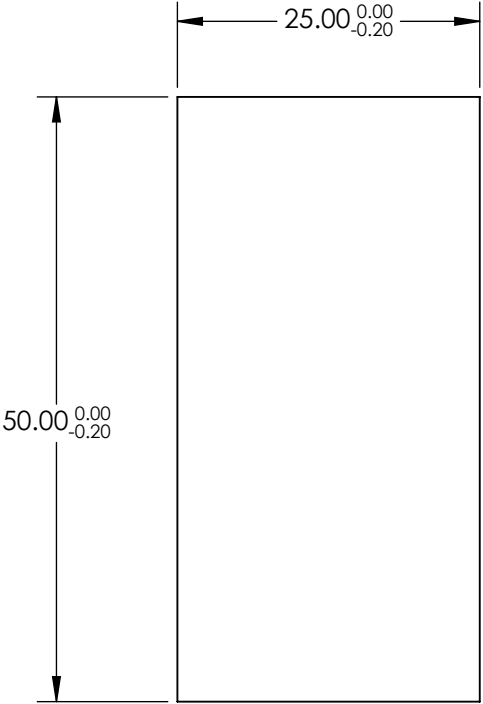

**FOR INFORMATION ONLY:  
DO NOT MANUFACTURE  
PARTS TO THIS DRAWING**

SPECIFICATIONS SUBJECT TO CHANGE WITHOUT NOTICE  
DIMENSIONS ARE FOR REFERENCE ONLY

	S1	S2	EFL	150.00	 <b>Edmund Optics®</b>		
SHAPE	CONVEX	PLANO	BFL	146.51			
RADIUS	77.78	INFINITY			TITLE	50mm H X 25mm L X 150mm FL VIS 0° COATED, CYLINDER LENS	
SURFACE QUALITY	60-40	60-40					
CLEAR APERTURE	49.00 x 24.00	49.00 x 24.00	ALL DIMS IN mm		DWG NO	69738	
BEVEL	PROTECTIVE AS NEEDED	PROTECTIVE AS NEEDED					
							SHEET 1 OF 1