

NOTES:

1. SUBSTRATE MATERIAL:  
N-BK7
2. COATING (APPLY ACROSS CLEAR APERTURE)
- S1 & S2: MgF2 (400-700nm)  
R(AVG) ≤1.75% @ 400 - 700nm

3. FINE GROUND SURFACE

4. RoHS COMPLIANT

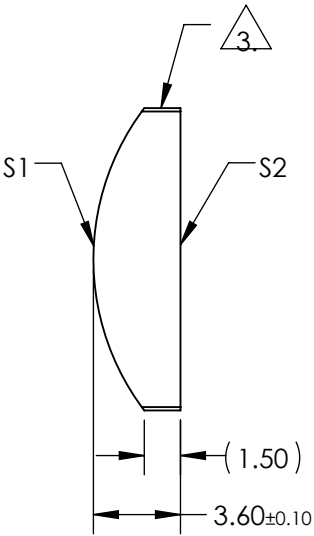
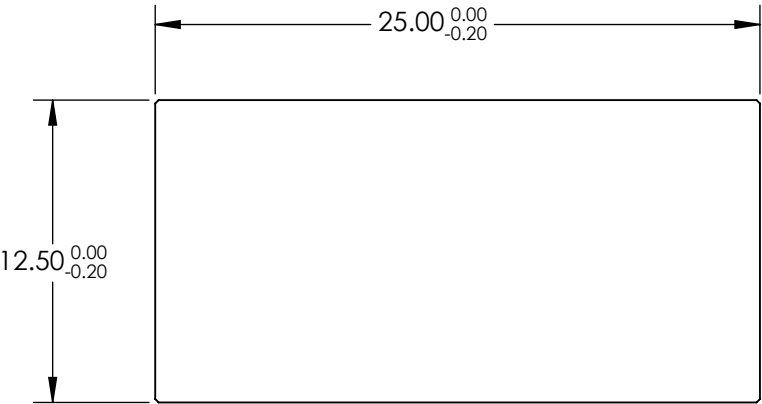

**FOR INFORMATION ONLY:  
DO NOT MANUFACTURE  
PARTS TO THIS DRAWING**

SPECIFICATIONS SUBJECT TO CHANGE WITHOUT NOTICE  
DIMENSIONS ARE FOR REFERENCE ONLY

	S1	S2	EFL	20.00	 Edmund Optics®		
SHAPE	CONVEX	PLANO	BFL	17.63			
RADIUS	10.34	INFINITY			TITLE	12.5mm H X 25mm L X 20mm FL MGF2 COATED,CYLINDER LENS	
SURFACE QUALITY	60-40	60-40					
CLEAR APERTURE	11.50 x 24.00	11.50 x 24.00			DWG NO	68045	
BEVEL	PROTECTIVE AS NEEDED	PROTECTIVE AS NEEDED	ALL DIMS IN	mm			
							SHEET 1 OF 1