

NOTES:

1. SUBSTRATE MATERIAL:
BOROFLOAT®
2. COATING (APPLY ACROSS CLEAR APERTURE)

S1: PROTECTED ALUMINUM
R(avg) >85% @ 400 - 700nm
R(avg) >90% @ 400 - 2000nm
DENSITY LIMIT: 0.3 J/cm² @ 532nm & 1064nm, 10ns
S2: NONE
3. POWER, IRREGULARITY, SURFACE QUALITY, AND COATING
SPECIFICATIONS APPLY ACROSS CLEAR APERTURE
4.

FINE GROUND SURFACE
5. ROHS COMPLIANT

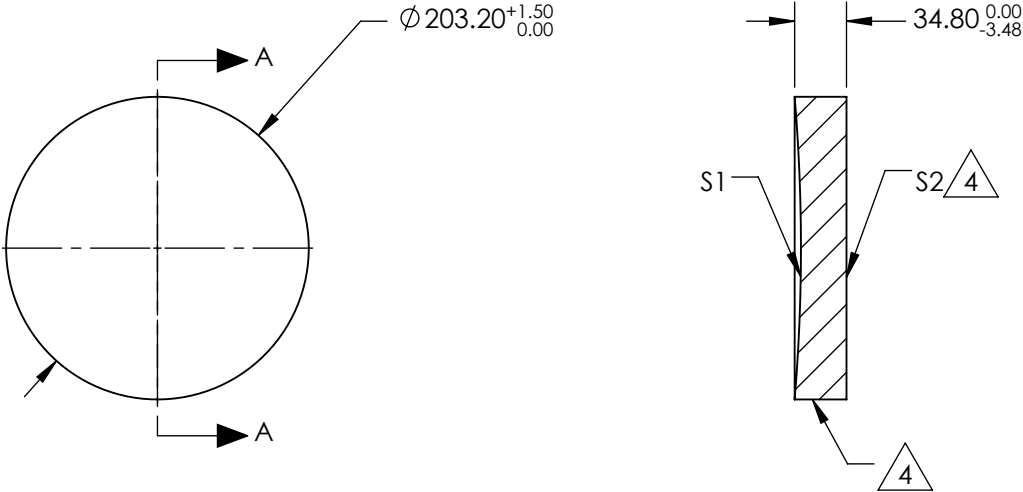

SECTION A-A

**FOR INFORMATION ONLY:
DO NOT MANUFACTURE
PARTS TO THIS DRAWING**

SPECIFICATIONS SUBJECT TO CHANGE WITHOUT NOTICE
DIMENSIONS ARE FOR REFERENCE ONLY

REV. A	S1	S2				
SHAPE	CONCAVE	PLANO				
EFFECTIVE FOCAL LENGTH	609.6mm	N/A				
FOCAL LENGTH TOLERANCE	±2%	N/A				
APERTURE	f/3	N/A				
SURFACE QUALITY	60-40	60-40				
SURFACE FLATNESS	λ/4	λ/4				
BEVEL	PROTECTIVE AS NEEDED	PROTECTIVE AS NEEDED				

THIRD ANGLE PROJECTION		TITLE		DWG NO		SHEET 1 OF 1	
ALL DIMS IN		mm		43588			

Edmund Optics®

Ø8in, 24in FL PROTECTED ALUMINUM,
SPHERICAL MIRRORS