

NOTES:

- 1. SUBSTRATE MATERIAL: N-BK7
- 2. BEAM DEVIATION: ± 5 ARCMIN
- 3. ROHS COMPLIANT
- 4. COATING (APPLY ACROSS CLEAR APERTURE)
 - S1 & S2: R(avg) >85% @ 400 - 700nm W/BLACK OVERPAINT
 - S3 & S4: R(avg) $\leq 1.75\%$ @ 400 - 700nm
 - S5: BLACK PAINT

5. FINE GRIND SURFACE

FOR INFORMATION ONLY:
DO NOT MANUFACTURE
PARTS TO THIS DRAWING

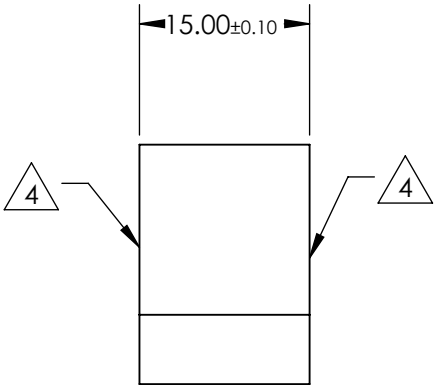
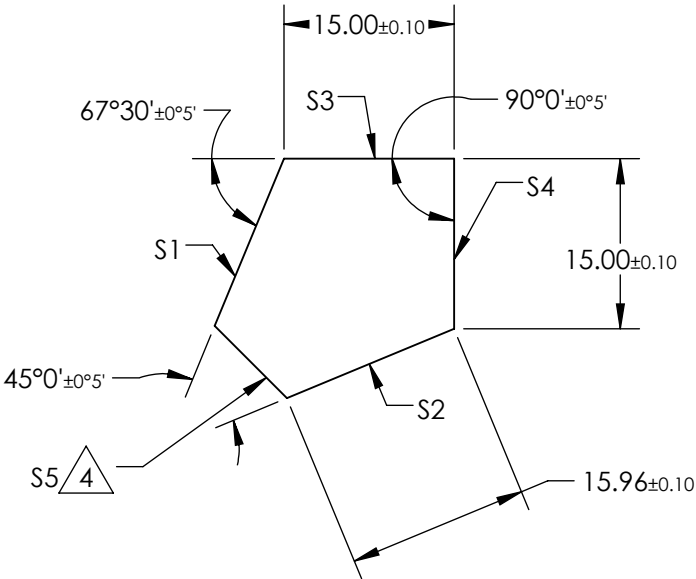

SPECIFICATIONS SUBJECT TO CHANGE WITHOUT NOTICE
DIMENSIONS ARE FOR REFERENCE ONLY

| | VALUE |
|------------------|----------------------|
| SHAPE | PLANO |
| ANGLE TOL. | ± 5 arcmin |
| SURFACE QUALITY | 60-40 |
| SURFACE FLATNESS | $\lambda/8$ |
| BEVEL | PROTECTIVE AS NEEDED |



ALL DIMS IN mm



| TITLE | 15mm, MgF2 COATED, PENTA PRISM |
|--------|--------------------------------|
| DWG NO | 43502 |
| SHEET | 1 OF 1 |