

NOTES:

1. ALLOWABLE OPTICAL MATERIAL:
ALUMINUM
2. FINISH (EXCEPT SURFACE S1):
BLACK ANODIZED
3. COATING (APPLY ACROSS COATING APERTURE)
S1: BARE GOLD
R(AVG) >94% @ 700 - 800nm
R(AVG) >97% @ 800 - 2000nm
R(AVG) >98% @ 2000 - 12000nm
SURFACE ROUGHNESS:
<175 Å RMS
4. FOCAL LENGTH TOLERANCE: ±1%
5. RoHS COMPLIANT

**FOR INFORMATION ONLY:
DO NOT MANUFACTURE
PARTS TO THIS DRAWING**

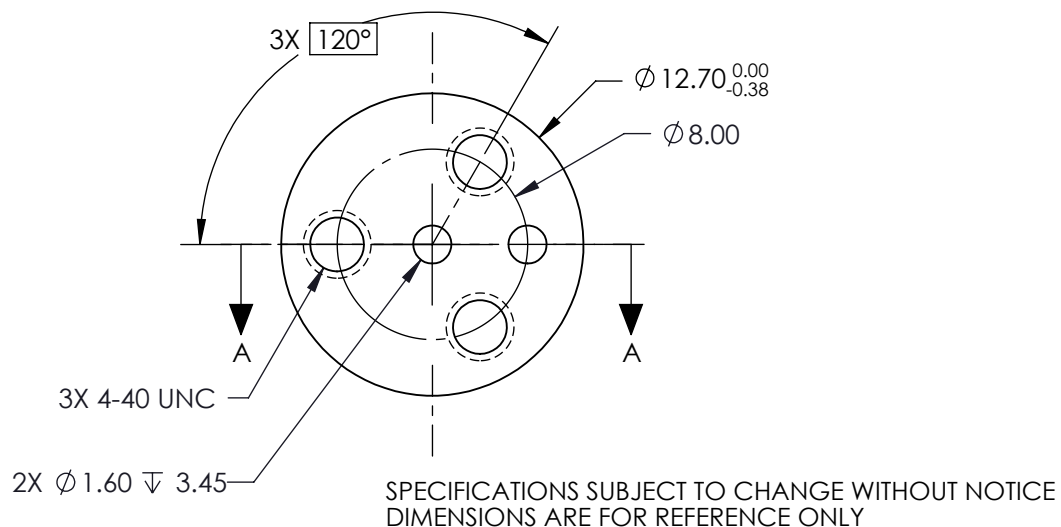
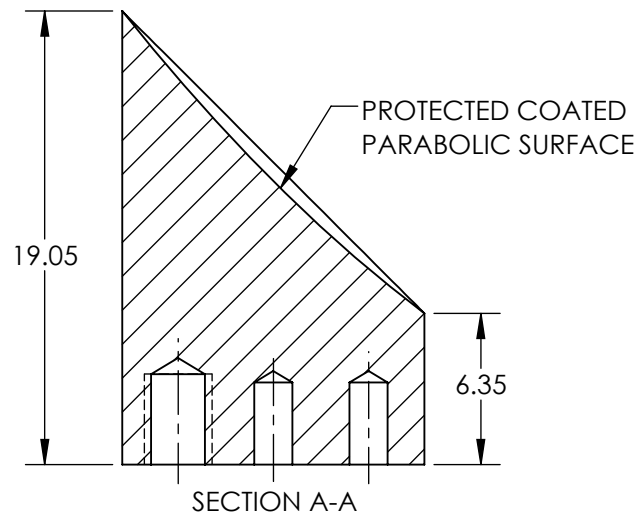
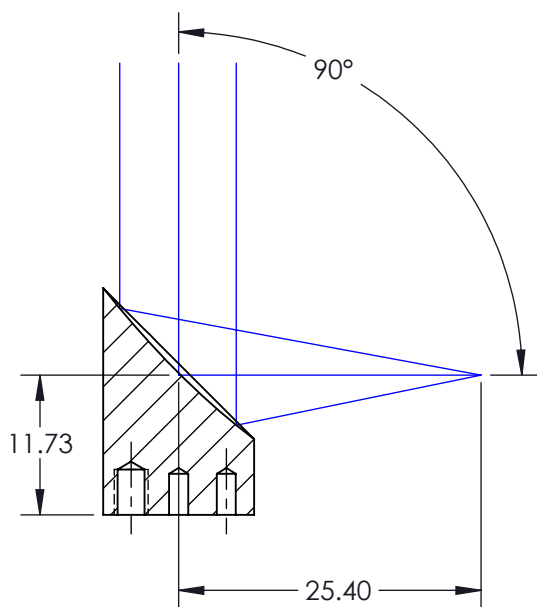

SPECIFICATIONS SUBJECT TO CHANGE WITHOUT NOTICE
DIMENSIONS ARE FOR REFERENCE ONLY

REV. A	S1
SHAPE	PARABOLIC
REFLECTIVE WAVEFRONT DISTORTION AT 632.8nm (RMS)	$\lambda/4$
SURFACE FIGURE AT 632.8nm (RMS)	$\lambda/8$
CLEAR APERTURE	90%
BEVEL	PROTECTIVE AS NEEDED

		Edmund Optics®	
THIRD ANGLE PROJECTION		TITLE	Ø12.7 x 25.4mm EFL 90° OAP BARE GOLD MIRROR 175Å
ALL DIMS IN	mm	DWG NO	34569
			SHEET 1 OF 1