

NOTES:

1. SUBSTRATE
2. SURFACE S2 TO BE PARALLEL WITH SURFACE S1 TO WITHIN 10 ARCSEC
3. COATING (APPLY ACROSS CLEAR APERTURE)
PHYSICAL DURABILITY: MIL-C-48497A
ENVIRONMENTAL DURABILITY: MIL-STD-810F
Tavg ≥93% @ 1077.8 - 2000nm
4. FINE GROUND SURFACE
5. POWER, IRREGULARITY, AND SURFACE QUALITY SPECIFICATIONS APPLY
ACROSS CLEAR APERTURE
6. TRANSMITTED WAVEFRONT DISTORTION RMS @ <λ/4 @ 633nm
7. RoHS COMPLIANT

**FOR INFORMATION ONLY:
DO NOT MANUFACTURE
PARTS TO THIS DRAWING**

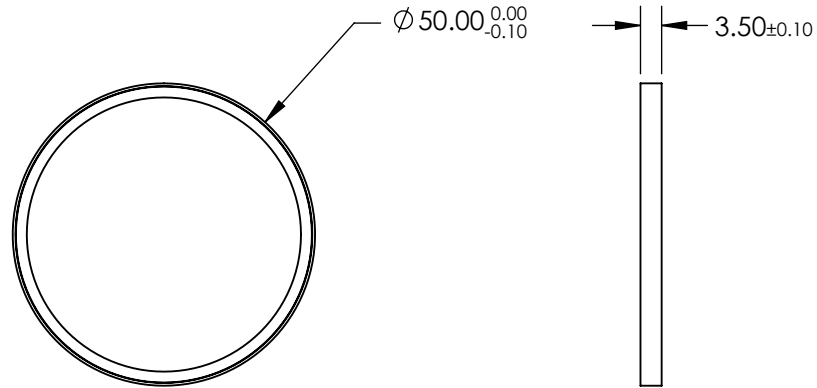
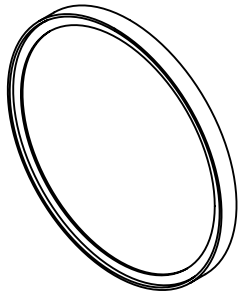

SPECIFICATIONS SUBJECT TO CHANGE WITHOUT NOTICE
DIMENSIONS ARE FOR REFERENCE ONLY

| REV. A | S1 | S2 | <div><div><div><div><div></div></div></div><div><div></div></div></div><div>THIRD ANGLE PROJECTION</div></div> <div><div>Edmund Optics®</div><div>Edmund Optics®</div></div> | | | |
|----------------------|----------------------|----------------------|--|----|-------|------------------------------------|
| SHAPE | PLANO | PLANO | | | | |
| REJECTION WAVELENGTH | 831 - 1064 | 831 - 1064 | | | | |
| SURFACE QUALITY | 60-40 | 60-40 | | | | |
| CLEAR APERTURE | Ø40 | Ø40 | | | | |
| BEVEL | PROTECTIVE AS NEEDED | PROTECTIVE AS NEEDED | | | | |
| | | | ALL DIMS IN | mm | TITLE | Ø50mm, 1074.6nm, RAMAN EDGE FILTER |
| | | | DWG NO | | 86266 | SHEET 1 OF 1 |