

NOTES:

1. SUBSTRATE
2. SURFACE S2 TO BE PARALLEL WITH SURFACE S1 TO WITHIN 10 ARCSEC
3. COATING (APPLY ACROSS CLEAR APERTURE)
PHYSICAL DURABILITY: MIL-C-48497A
ENVIRONMENTAL DURABILITY: MIL-STD-810F
Tavg ≥93% @ 992.7 - 2000nm
4. FINE GROUND SURFACE
5. POWER, IRREGULARITY, AND SURFACE QUALITY SPECIFICATIONS APPLY
ACROSS CLEAR APERTURE
6. TRANSMITTED WAVEFRONT DISTORTION RMS @ <λ/4 @ 633nm
7. RoHS COMPLIANT

**FOR INFORMATION ONLY:
DO NOT MANUFACTURE
PARTS TO THIS DRAWING**

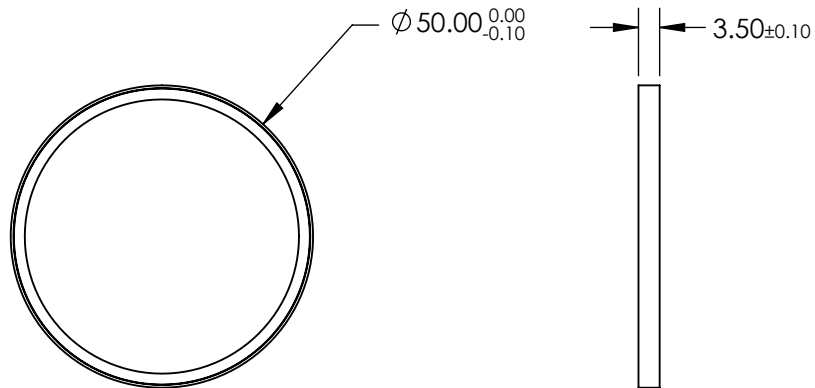
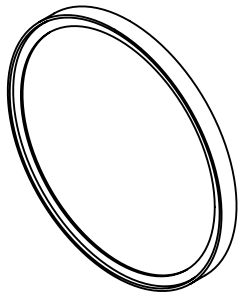

SPECIFICATIONS SUBJECT TO CHANGE WITHOUT NOTICE
DIMENSIONS ARE FOR REFERENCE ONLY

REV. A	S1	S2	<div><div><div><div><div></div></div></div><div><div>THIRD ANGLE PROJECTION</div></div></div><div><div>ALL DIMS IN</div><div>mm</div></div></div> <div><div><div><div><div></div></div></div><div><div>Edmund Optics®</div></div></div><div><div>TITLE</div><div>Ø50mm, 989.8nm, RAMAN EDGE FILTER</div></div><div><div>DWG NO</div><div>86265</div></div><div><div>SHEET</div><div>1 OF 1</div></div></div>
SHAPE	PLANO	PLANO	
REJECTION WAVELENGTH	770 - 980	770 - 980	
SURFACE QUALITY	60-40	60-40	
CLEAR APERTURE	Ø40	Ø40	
BEVEL	PROTECTIVE AS NEEDED	PROTECTIVE AS NEEDED	